

651PS

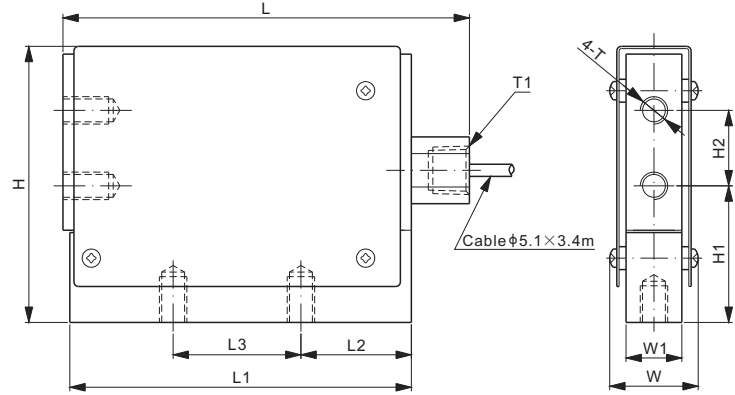

Stainless Steel

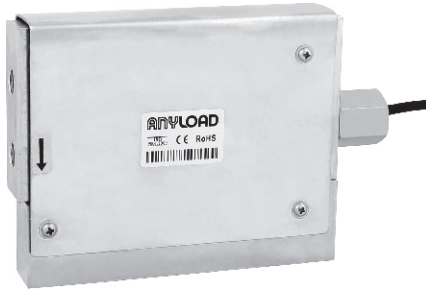

CE RoHS

DIMENSIONS

RATED CAPACITY	H	H1	H2	L	L1	L2	L3	W	W1	T	T1
lb/inches											
50	4.75	2.35	1.30	7.00	5.88	1.90	2.20	1.52	0.96	M12 Depth20	1/2-14-NPT
kg/mm (conversion of above dimensions)											
22.68	120.7	59.7	33.0	177.8	149.4	48.3	55.9	38.7	24.4	M12 Depth0.79	1/2-14-NPT

SPECIFICATIONS

Full Scale Output	2.000 - 2.002 mV/V	Recommended Excitation	10V (15V Maximum)
Zero Balance	± 0.02 mV/V	Reference Max. Platform Size	400×400 mm
Non-linearity	< ± 0.02%	Insulation Resistance	>2 [50V DC] GΩ
Repeatability	< ± 0.02%	Compensated Temperature Range	-10°C to 50°C / 14°F to 122°F
Hysteresis Error	< ± 0.02%	Safe Overload	150% of full scale
Creep in 30 min.	< ± 0.03%	Breaking Overload	300% of full scale
Input Resistance	450Ω ± 100	Seal Type / IP Rating	Environmentally Sealed / IP66
Output Resistance	350Ω ± 3	Cable Color Code	Exc+ Red Exc- Black Sig+ Green Sig- White Shield Bare
Element Material	17-4PH Stainless Steel		

PART NUMBER

Rated Capacity	Part No.	Shipping Weight (kg) Approx.
50lb.....	651PS-50lb.....	2.9

SINGLE POINTS