

101NH

S-Beam Load Cell

IP67

ALLOY STEEL

Options:

- 35ft (10.5m) Cable
- With Flexible Strain Relief
- FM, ATEX, IECEx Approved

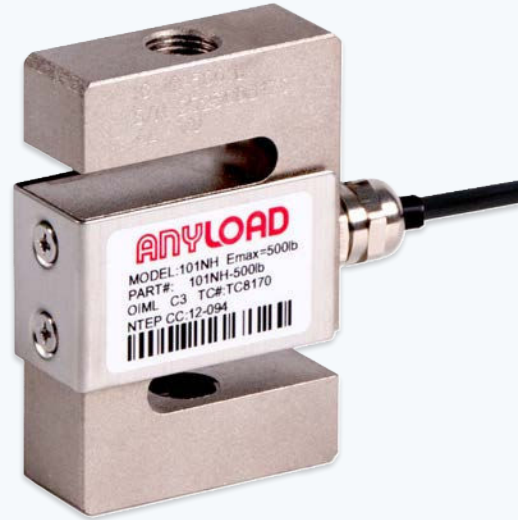

101NHM2

Tension Weigh Module

ALLOY STEEL

Features:

- High accuracy tension loading
- Grounding strap included to divert stray currents and protect the load cell





Part Number / Capacity	J-Box	Cable
3 Module Kit	*J-Box (specify model when ordering)	
MK3-101NHM2- 250lb-S	J04SA-16	1 roll (65ft/20m)
MK3-101NHM2- 500lb-S		
MK3-101NHM2- 1Klb-S		
MK3-101NHM2- 1.5Klb-S		
MK3-101NHM2- 2Klb-S		
MK3-101NHM2- 5Klb-S		
MK3-101NHM2-E- 10Klb-S		
4 Module Kit	*J-Box (specify model when ordering)	
MK4-101NHM2- 250lb-S	J04SA-16	1 roll (65ft/20m)
MK4-101NHM2- 500lb-S		
MK4-101NHM2- 1Klb-S		
MK4-101NHM2- 1.5Klb-S		
MK4-101NHM2- 2Klb-S		
MK4-101NHM2- 5Klb-S		
MK4-101NHM2-E- 10Klb-S		

Complete Kit Includes

- ✓ 101NH Load Cells
- ✓ 101NHM2 Mounts
- ✓ Junction Box (Signal or Exc)
- ✓ Load Cell Cable

Features

- Capacities (per module) 50lb-10,000lb
- Stray currents can go through the grounding strap bypassing the load cell
- High accuracy tension loading
- Grounding strap included to divert stray currents and protect the load cell

Applications

- Concrete Batching Plants
- Suspended Hoppers & Tanks
- Tension & Compression Force Testing

MK4 J-Box: Signal or Excitation / Aluminum, Stainless Steel or Fiberglass Enclosure

Drawings

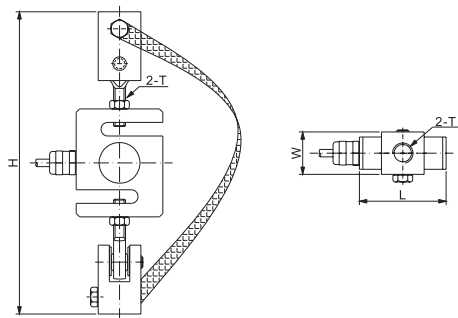

Dimensions (inches)

Capacity	H _{Min/Max}	W	L	T	T1
50-250lb	6.69/7.09	0.99	2.00	1/4-28 UNF-2A	1/2-13 UNC-2B
500lb-2,000Klb	9.57/9.88	1.58	2.00	1/2-20 UNF-2A	3/4-10 UNC-2B
500lb-2,000Klb (-A)	9.57/9.88	1.58	2.00	1/2-20 UNF-2A	1/2-13 UNC
5,000Klb	12.13/12.60	2.16	3.00	3/4-16 UNF-2A	3/4-10 UNC-2B
10,000Klb	17.17/18.07	3.15	3.15	3/4-16 UNF-2A	1-8 UNC-2B