

# 108LAMT

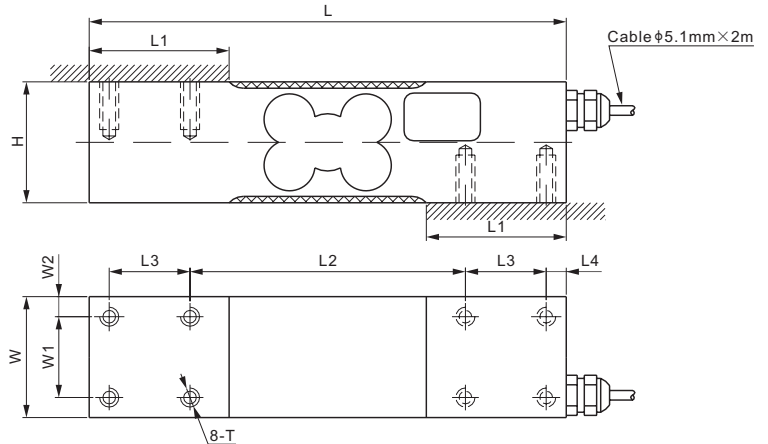

## Aluminum



### DIMENSIONS

RATED CAPACITY	H	L	L1	L2	L3	L4	W	W1	W2	T
<b>kg/mm</b>										
30-300	38.0	150.0	44.0	86.6	25.4	6.3	38.0	25.4	6.3	M6 Depth 15
<b>lb/inches</b> (conversion of above dimensions)										
66-661	1.50	5.91	1.73	3.41	1.00	0.25	1.50	1.00	0.25	M6 Depth 0.59

### SPECIFICATIONS

<b>Full Scale Output</b>	2.0 mV/V ± 10%	<b>Recommended Excitation</b>	10V (15V Maximum)
<b>Zero Balance</b>	± 0.02 mV/V	<b>Reference Max. Platform Size</b>	500×500 mm
<b>Non-linearity</b>	< ± 0.017%	<b>Insulation Resistance</b>	>2 [ 50V DC ] GΩ
<b>Repeatability</b>	< ± 0.017%	<b>Compensated Temperature Range</b>	-10°C to 40°C / 14°F to 104°F
<b>Hysteresis Error</b>	< ± 0.017%	<b>Safe Overload</b>	150% of full scale
<b>Creep in 30 min.</b>	< ± 0.023%	<b>Breaking Overload</b>	300% of full scale
<b>Input Resistance</b>	385Ω ± 15	<b>Seal Type / IP Rating</b>	Environmentally Sealed / IP66
<b>Output Resistance</b>	350Ω ± 3	<b>Cable Color Code</b>	Exc+ Red    Exc- Black Sig+ Green    Sig- White    Shield Bare
<b>Element Material</b>	Aluminum, Clear Anodized		

### PART NUMBER\*

Rated Capacity	Part No.	Shipping Weight Approx. (kg)
30kg.....	108LAMT-30kg.....	0.6
50kg.....	108LAMT-50kg.....	0.6
60kg.....	108LAMT-60kg.....	0.6
100kg.....	108LAMT-100kg.....	0.6
150kg.....	108LAMT-150kg.....	0.6
200kg.....	108LAMT-200kg.....	0.6
300kg.....	108LAMT-300kg.....	0.6

\* ATEX, FM, IECEx approved versions carry the "-Ex" suffix.

### INTERCHANGEABLE PRODUCTS

Brand	Model
Mettler-Toledo.....	MT1241

### AVAILABLE OPTIONS

- Stainless Steel 2Cr13 version: 108LSMT (page 71)