

ANYLOAD®

Compression Weigh Modules

MODEL MK4-363TSM1



M K 4 - 3 6 3 T S M 1

FEATURES:

- 3° natural allowance for off-center loading
- Low profile, best-in-class performance
- Combined load cell and weigh mount for simple installation
- Side load and uplift protection up to 50% of rated capacity
- Optional top plate with threaded top holes for symmetrical mounting
- 17-4PH stainless steel construction (IP68/IP69K hermetic seal)



J04SS

**pictures for illustrative purpose only, the real product may differ.*

MK4-363TSM1

Weigh Module Kit

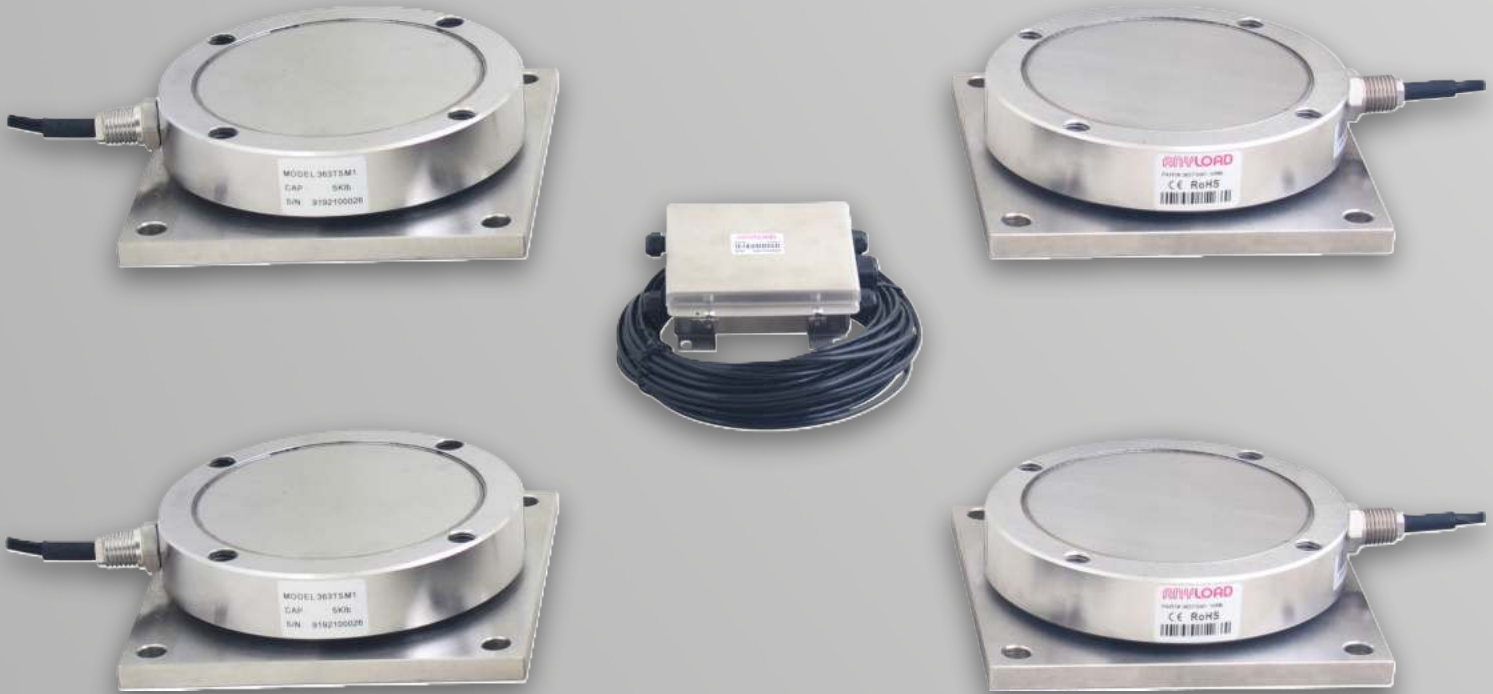

DESCRIPTION:

The 363TSM1 ThinWeigh® leads the industry as an integrated compression weigh module that is high capacity and ultra low-profile, ideally suited for tank, hopper, and vessel weighing. Our patented internal design significantly improved accuracy and repeatability compared to the traditional load pin design while also improving performance under variable loading conditions and temperature fluctuations. The ThinWeigh® is a superior alternative to conventional weigh modules.

J04SS (INCLUDE IN KIT)

363TSM1

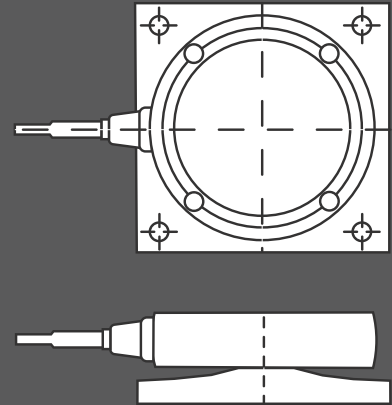
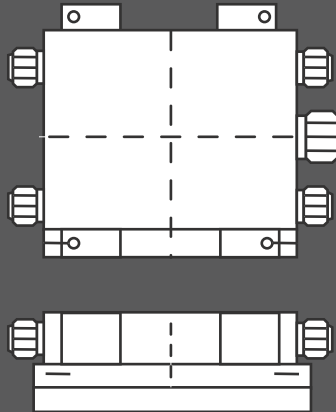

PART NUMBER

Part No.	Load Cell Capacity
MK4-363TSM1-2.5Klb-S.....	2.5Klb.....
MK4-363TSM1-5Klb-S.....	5Klb.....
MK4-363TSM1-10Klb-S.....	10Klb.....